

# SF B 500 Table top dough sheeter



## MAIN FEATURES



- Laminating cylinders length 500mm
- **Motorized and liftable** worktops to reduce footprint when not in use
- Reverse sheeting direction using **directional bar**
- **Flour holder** on the top cover
- **Precise and consistent** thickness adjustment
- **Easily removable scrapers** for daily cleaning at end of the working day
- **Flour-collecting trays** supplied as standard
- **Sheet collecting extensions** supplied as standard
- Available models: single-phase or three-phase
- Available with 710 or 950mm worktops

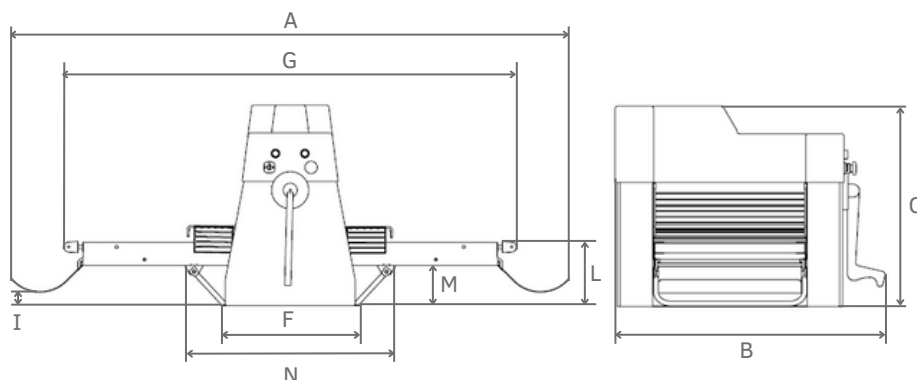

Model	SF B 500/710	SF B 500/950
Cylinder length(mm)	500	500
Cylinder diameter (mm)	60	60
Max cylinder opening (mm)	35	35
Worktop length (mm)	710	950
Power (kW)	0,75	0,75
Weight (kg)	117	126
A (mm)	1800	2320
B (mm)	880	880
C (mm)	650	650
F (mm)	420	420
G (mm)	1470	1950
I (mm)	70	70
L (mm)	210	210
M (mm)	135	135
N (mm)	620	620

Warnings:  
Uses other than those envisaged by the Manufacturer must be authorized by the same.  
It is not possible to claim rights the data, descriptions and illustrations.



KMP Srl  
Sede legale: Via del lavoro, 45  
z.i.Molina- 36034 Malo (VI)

+39 0445 637222  
+3 90445 370307

[www.kmp.srl](http://www.kmp.srl)  
mail: [info@kmp.srl](mailto:info@kmp.srl)  
pec: [kmp.srl@legalmail.com](mailto:kmp.srl@legalmail.com)